

FINANCIAL ASSISTANCE FOR MINERAL EXPLORATION (M.E.I.G.A.)

COMPANY: CONSOLIDATED GOLDFIELDS LTD

REF: AE 3

PROJECT: SCOTLAND AND N. ENGLAND MOLYBDENITE STUDY

MRD 84/2/4 & 8

MRD 144/2/4

The following Open File material is held by B.G.S. in London, Keyworth, Newcastle and Edinburgh. Available for public inspection from 23.11.86.

- OS sheet 2 showing location of Assynt, South Harris, Scourie.
1" : 4 miles.
- * Extracts from application 30.7.71:
"Outline of proposed project geological considerations
.... work programme" with the following overlays:
 - (a) No.2, 1" : 10 miles Areas of interest of G.B. sheet 1.
25.6.71. Scotland and N. England Mo and other metals
 - (b) No.3, 1" : 1 mile Geological Survey, sheet 23, of the
Cockermouth area 28.7.71
 - (c) ‡ No.4. 1" : 1 mile. O.S. Sheet 90. Gassington Area
- * Extract "Copper Nickel and Molybdenite projects" from CGF
letter dated 13.8.71
- Extract from Supplementary Application 5.6.72 "outline of
project and geological considerations"
- Letter from CGF dated 5.6.72 (RE: merger of AE2 and 3)
- " " " 30.6.72 " " " "
- Technical report 2.8.71 to 5.6.72 by E.M. Jones (submitted
with application 30.5.74 (AE3)) with negatives 1 to 43 of
the following:

Talnotry and Creetown

1. Creetown, reconnaissance stream sediment results Copper/
Molybdenum/Tin/Tungsten.
2. Talnotry Forests, reconnaissance stream sediment results
Copper/Molybdenum
3. Talnotry Forests (Part): reconnaissance stream sediment
results, Nickel
4. Talnotry Molybdenum Areas - Little water of Fleet: soil
sampling Molybdenum
5. Talnotry Molybdenum Areas - Loch Ken: soil sampling Molybdenum
results

. . . . (continued)

- 6. Talnotry Molybdenum Areas - Craighlowrie: soil sampling Molybdenum results
- 7. Talnotry Mine Area - reconnaissance soil sampling Copper/Nickel
- 8. Talnotry Mine Area - vertical magnetic intensity, reconnaissance survey
- 9. Talnotry Mine Area - detail soil sampling Copper/Nickel
- 10. Talnotry Mine - Vertical magnetic intensity, detailed survey

Cockermouth

- 11. Reconnaissance stream sediment sampling, Cu, Pb, Zn, 2½" : 1 mile. May '71
- 12. Reconnaissance soil sampling results: Copper NY13NE, NY23NW. 6" : mile. April '72
- 13. " " " " " " Lead and zinc, NY13NE, NY23NW. 6" : 1 mile. April '72
- * 14. " " I.P. Chargeability values
- * 15. " " I.P. Resistivity values
- * 16. " " I.P. Gradient Array chargeability values
- 17. Pit profiles and Geochemical profiles Copper, Lead, Zinc, Mercury. 6" : 1 mile. May '72
- ‡ 18. Detailed soil profile sampling, Cu, Pb, Zn. 25" : 1 mile. Oct '72
- ‡ 19. Section, lines C-K, Cu, 2 cm = 100'. Oct '72
- ‡ 20. " " " Pb, " " "
- ‡ 21. " " " Zn, " " "
- ‡ 22. Detailed IP chargeability values. 25" : 1 mile. Oct '72. Extended Dec '72
- ‡ 23. Resistivity values. 25" : 1 mile. Oct '72. Extended Dec '72

. . . . (continued)

Dalbeattie

- 24. Reconnaissance stream sediment sampling results. Copper, Molybdenum, Tin, Tungsten
- 25. Aireland Moor soil sampling results - Molybdenum
- 26. " " " " " - Copper
- 27. Barclosh Hill " " " - Molybdenum
- 28. " " " " " - Copper
- 29. Rascarrell soil sampling results - Copper
- 30. Barcloy - Whitehills soil sampling results - Copper
- 31. " " " " " " " - Molybdenum
- 32. Colvend, detail soil sampling - Copper
- 33. Cushat Wood - Airdrie farm Follow up stream sediment results Copper, Lead, Zinc

Mullach

- 34. Reconnaissance stream sediment sampling results, Copper, Molybdenum
- 35. Follow-up stream sediment sampling results, Copper, Molybdenum
- 36. Soil sampling results, Copper, Molybdenum

Clerich (Aviemore)

- 37. Reconnaissance stream sediment sampling results, Copper, Molybdenum
- 38. Alvie Estate; soil sampling results, Copper, Molybdenum
- 39. " " " " " " Molybdenum
- 40. Kinreathy Estate; soil sampling results and follow-up stream sediment results, Copper/Molybdenum
- 41. Kinreathy Estate; soil sampling. South extension of grid. Sample location Copper/Molybdenum

. . . . (continued)

Fearn

42. Reconnaissance stream sediment sampling results, Copper, Molybdenum

43. Follow-up stream sediment sampling results

- Report dating 6.6.72 to 30.6.73, extended to 31.3.74 (AE3/2) by EMJ with enclosure Fig 6. Talnotry Molybdenum areas soil sampling Cu/Mo results
- Extract from second supplementary application 3.4.74 ".... outline of project work programme"
- * Letter from company dated 7.11.75. Re claim 3/3
- Report by E.M. Jones 7.11.75 on Assynt with the following enclosures:
 - Figs 1 to 12. Geology and Rock sample locations, 6" : 1 mile, July 1974
 - Figs 13 and 14. Stream sediment results, 1 : 63360, OS map 13
 - Fig 15. Soil grid results
 - Figs 16-17. Reconnaissance magnetometry survey
 - Fig 18. Follow-up soil sampling
 - Fig 19. IP resistivity
 - Fig 20. Chargeability
 - Fig 21. Metal factor
 - Fig 22. Magnetometer survey
 - Table 1. Rock assay results

. . . . (continued)

- Report by E.M. Jones, 7.11.75 on South Harris, with the following enclosures:

Fig 1. Soil sample results, Copper, Nickel, Zinc

Fig 2. Rock sample results, Copper, Nickel, Zinc

Table 1. Rock samples. Petrology results

- Report by E.M. Jones 7.11.75 on Scourie with the following enclosures:

§# 1 Reconnaissance stream sample results, Cu, Ni, Zn, 1" : 1 mile

§# 2 Soil and stream sediment results, Zn 6" : 1 mile

§# 3 " " " " " " "

§# 4 " " " " " " "

§# 5 " " " " " " "

§# 6 " " " " " " "

§# 7 I.P. apparent resistivity, 1 : 2,500

§# 8 I.P. chargeability, 1 : 2,500

§# 9 I.P. metal factor, 1 : 2,500

§# 10 Magnetometer survey (based on I.P. grid) 1 : 2,500

§# 11 Soil sampling results; Cu, Pb, Ni, Zn, 1 : 2,500

- * Letter from CGF dated 17.5.76 enclosing the rock descriptions, PSE series, for the Scourie samples PSR 1 to 44

- Extracts (1 to 8 inc) from 3rd supplementary application 12.11.75 with enclosures 1 to 8

1. Part of OS sheet no. 9, 1" : 1 mile

2. Part of sheet NC24 NW, 6" : 1 mile

3. IP chargeability map, 1 : 2500

4. IP resistivity map, 1 : 2500

5. E.M. map, Scourie area

6. E.M. imaginary component, high frequency Scourie

7. IP profiles, Scourie

8. IP profiles, Foindle

Technical Report for 24.11.75 to 1.6.76 (stage 4), with enclosures:

Figs 1 and 2, Drill sites SBH 1 to 5, 1:2500, OSNC14NE, 17.3.76

Figs 3 to 6 Geophysical profiles, geological sections and sulphide content of core 1 cm = 25'. 7.3.76

Table 1. Precious metal analyses

Table 2. Multi-element spectrographic scan results

Appendix 1. Geological graphic and sulphide logs SBH 1 to 5

*‡ Appendix 2. Petrographic report

‡ Estimated abundances of rock types of sulphides in boreholes (2 tables)

‡ Not in London * Not in Keyworth § Not in Edinburgh

AE 3 is closely related to AE 2 and AE 130

SCOTLAND AND NORTH OF ENGLAND MOLYBDENITE etc. AEBTechnical Report for period 2nd August 1971 - 5th June 1972

During the period geological reconnaissance and stream sediment surveys were undertaken in 16 areas. The results of this work caused many of the areas to be given up but 7 localities merited further investigation.

1. Reconnaissance Geochemistry

As the project had been underway for 6 months before the mineral incentive scheme became operative some of the reconnaissance geochemical surveys had already been carried out. Where follow-up work was undertaken however, non-qualifying reconnaissance results accompany this submission in order to complete the overall picture.

Areas given up after the reconnaissance stage:-

Craven faults, Etive, Moy and Foyers,
Arran, Cluanie, Inchbae, Skelpick,
Scourie, Skye.

74 * Field checks were undertaken in some areas before the ground was relinquished, and in the case of Scourie and Skelpick further access was refused to the properties involved and it has not been possible to follow-up initially encouraging results. If access is obtained at a later date to either of these areas, then a separate grant application will be made to cover any work undertaken.

2. Follow-up Geochemistry and Geophysics

Further work was merited in the following areas, each of which is discussed individually.

Talnoy, Cockermouth, Dalbeattie, Creetown,
Mullach nan Coirean and Ballachullish, Clerich,
Fearn.

This work screened out all of the remaining areas apart from Cockermouth where a scout drilling target was located. The diamond drilling programme formed the basis of a separate grant application and this area has now been isolated under the Tompenhow project. The record of the work leading up to the drilling stage

has been included with this and the subsequent submissions.

2.1 Talnotry and Creetown

NX 4285

The reconnaissance of the Talnotry and Creetown areas located a series of molybdenum anomalies along the southern side of the Cairnsmore of Fleet granite, and the two areas were considered jointly for follow-up work. Low order copper anomalies on the northern side of the Fleet granite and along the southern margin of the Merrick granite were also checked. Soil geochemical and magnetic surveys were undertaken in the vicinity of the exposed nickel mineralisation in an attempt to discover any concealed extensions.

NX 4364
N 4 6000

Amongst the molybdenum anomalies the three strongest (Craiglowrie Hill, Loch Ken, Little Water of Fleet) were investigated geochemically, by further stream sampling, base of slope soil sampling and soil sampling along the forestry rides. Enhanced values were located in soils at Craiglowrie Hill and minor non-economic molybdenite mineralisation was found to be the source of the anomaly. Both at Loch Ken and Little Water of Fleet the anomalies proved to be very small in extent with no increase in values. The results are attributed to very minor molybdenite within the granite possibly enhanced by manganese precipitation in the streams.

Low order stream sediment anomalies on the northern side of the Fleet granite were traced to minor chalcopyrite mineralisation in quartz veins. Whereas similar low order values along the southern flank of the Merrick granite emanate from the pyritic black shales exposed in that area.

Geological mapping, reconnaissance soil sampling and magnetic surveys were undertaken in the vicinity of the copper/nickel mineralisation exposed in Glen of the Bar, and the central part of the grid was surveyed in detail. The results of the detailed work confirm that the mineralisation has a very limited extent. No manifestation of possible lateral extensions were obtained from the more widely-spaced surveys, and it was concluded that no extensions to the known mineralisation exist, within the range of the techniques used.

2.2. Cockermouth

Reconnaissance soil and stream sediment sampling outlined a large but moderate copper anomaly in Cockermouth Area. Follow-up soil sampling confirmed the continuity and extent of this anomaly. A reconnaissance I.P. survey was carried out but unfortunately a buried water main interfered with this survey over the main anomalous zone. Further detailed work will be undertaken in the autumn of 1972 which, if encouraging will justify the isolation of this area from project AE3 to become the subject of a separate grant application.

2.3 Dalbeattie

Following the reconnaissance stream sediment survey soil sampling was undertaken in four areas where anomalous values were recorded; Aireland Moor, Barclosh Hill, Barclay-Whitehills and Rascarrel. Closely-spaced stream sediment samples were collected in Cushat Wood following up some results supplied by the I G S. Here the anomalous lead/zinc values were traced back to an out-cropping barytes vein.

At Aireland Moor the soil sampling located scattered and discrete anomalies for both copper and molybdenum that will require further follow-up.

The soil sampling at Barclosh Hill did not reveal any anomalous values and no further work was undertaken.

Anomalous values for copper up to 840 p.p.m. were recorded near Colvend on the Barclay-Whitehills grid. These values were further investigated with detailed soil sampling which showed that the anomaly was completely confined to an area of very peaty soil. No further work was undertaken.

Soil sampling was also undertaken at Rascarrel in search of extensions to the recorded copper mineralisation in that area. No anomalies worthy of further work were discovered.

2.4 Mullach nan Coirean (Mullach nan Coirean)

Moderately anomalous molybdenum values were located along the southern and western contacts of the Mullach nan Coirean granite, as well as low order copper values. The copper occurs only in streams draining black pyritic shales and geochemical checks on rock samples confirmed the black shales as the source of copper. Along the

contour, soil sampling was carried out over the molybdenum anomalies, and the results required further follow up.

2.5 Clerich (Aviemore)

Reconnaissance sampling in this area revealed two groups of strongly anomalous values, one on the Alvie Estate and the second near Aviemore. On the Alvie Estate soil sampling outlined an anomalous zone close to the granite contact with some other scattered anomalous values. Both this and the anomaly near Aviemore require extensions of the original grid in order that the potential of the area may be fully assessed.

2.6 Fearn

A moderate anomaly was scheduled for further work in this area, and it was repeated with closely-spaced stream sediment sampling. It is intended that follow up soil sampling will be carried out.

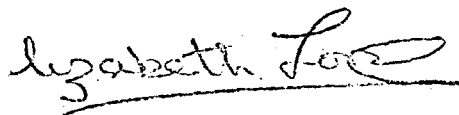

Elizabeth Jones

(In Map Cabinet)

LIST OF ENCLOSURES

Talnotry and Creetown

1. Creetown, reconnaissance stream sediment results
Copper/Molybdenum/Tin/Tungsten. ✓ x
2. Talnotry Forests, reconnaissance stream sediment
results Copper/Molybdenum. ✓ x
3. Talnotry Forests (Part): reconnaissance stream
sediment results, Nickel. ✓ x
4. Talnotry Molybdenum Areas - Little water of Fleet: x
soil sampling Molybdenum. ✓
5. Talnotry Molybdenum Areas - Loch Ken: soil sampling x
Molybdenum results. ✓
6. Talnotry Molybdenum Areas - Craighlowrie: soil ✓
sampling Molybdenum results. ✓
7. Talnotry Mine Area - reconnaissance soil sampling
Copper/Nickel. ✓ x
8. Talnotry Mine Area - vertical magnetic intensity,
reconnaissance survey.
9. Talnotry Mine Area - detail soil sampling Copper/Nickel. ✓ x
10. Talnotry Mine - Vertical magnetic intensity, detailed
survey.

Cockermouth

11. Reconnaissance stream sediment sampling. ✓
12. Reconnaissance soil sampling results: Copper. ✓
13. " " " " : Lead and Zinc. ✓
14. " I.P. Chargeability values. ✓
15. " I.P. Resistivity values. ✓
16. " I.P. Gradient Array chargeability values.
17. Pit profiles and Geochemical profiles Copper, Lead, Zinc, ✓
Mercury. ✓

(In Map Cabinet)

Dalbeattie X

- / 24. Reconnaissance stream sediment sampling results.
Copper, Molybdenum, Tin, Tungsten. ✓
- / 25. Aireland Moor soil sampling results - Molybdenum. ✓
- / 26. " " " - Copper. ✓
- / 27. Barclosh Hill " " - Molybdenum. ✓
- / 28. " " " - Copper. ✓
- / 29. Rascarrell soil sampling results - Copper. ✓
- / 30. Barcloy - Whitehills soil sampling results - Copper. ✓
- / 31. " " " - Molybdenum. ✓
- / 32. Colvend, detail soil sampling - Copper. ✓
- / 33. Cushat Wood - Airdrie farm F.U. stream sediment results
Copper, Lead, Zinc.

Mullach

- / 34. Reconnaissance stream sediment sampling results,
Copper, Molybdenum. ✓
- / 35. Follow-up stream sediment sampling results, Copper,
Molybdenum. ✓
- / 36. Soil Sampling results, Copper, Molybdenum. ✓

Clerich (Aviemore)

- / 37. Reconnaissance stream sediment sampling results,
Copper, Molybdenum. ✓
- / 38. Alvie Estate; soil sampling results, Copper, Molybdenum. ✓
- / 40. Kinreathy Estate; soil sampling results and follow-
up stream sediment results, Copper/Molybdenum. ✓

Fearn.

- / 42. Reconnaissance stream sediment sampling results,
Copper, Molybdenum. ✓
- / 43. Follow-up stream sediment sampling results. ✓

COMMERCIAL: IN CONFIDENCE

990,000

To Lairg

Bonar Bridge

Dornoch

DORNOCH
FIRTH

Fearn
Granite

Tain

Loch Muigh
Shiaraidh

Loch Beag
Ait Muigh-Bioraidh

Consolidated Gold Fields Limited

DRG No.
13

Area: FEARN

Title: FOLLOW-UP STREAM SEDIMENT SAMPLING

EXPLOSIVE

4/17 VALUES CORRECTED/RECALCULATED

AEB/1/13

OS Map No. 21

Scale: 1:50,000

Date: 1971

Prepared by: J.S.

Drawn by: J.S.

COMMERCIAL: IN CONFIDENCE

Consolidated Gold Fields Limited		DRS. No. 34
Area: MULLACH WASH LOIARAN		
Title: STREAM SEDIMENT RESULTS		
COPPER		AES/374
MOLYBDENUM		
O.S. Map No.	46	
Scale: 1" to 1 mile		Date: May 1971
Prepared by: ERP		Drawn by: CAP

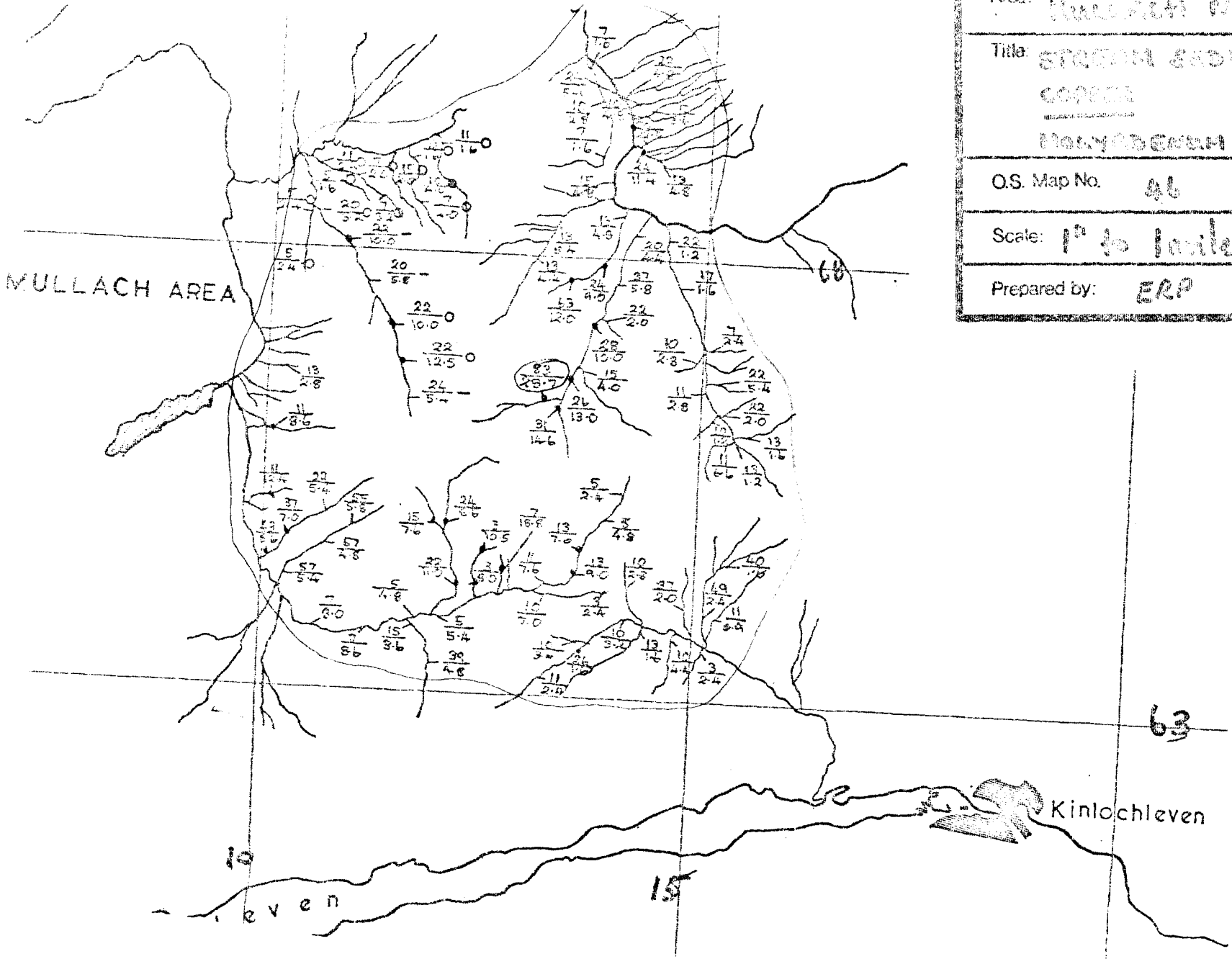



Commercial Gold Fields Ltd.
 SECTION 70/10/11

SAMPLE NUMBERS LS301-LS44
 Number Sequence $\frac{200 \text{ Copper}}{2000 \text{ Silver}}$

AE3/42

Scale 1:5000
 Date 12th May 1951
 Drawn by J.S.

JM



Mullach
nan Coirean

Stob Ban

Consolidated Gold Fields Limited		DRG No.
		35
Area: MULLACH NAN COIREAN		
Title: FOLLOW-UP STREAM SEDIMENT SAMPLING		
		AE3/35
O.S. Map No. INVERNESS CLX, CLXVI		
Scale: 6" to 1 mile	Date: February 1972	
Prepared by: ERF	Drawn by: ATW	

KI

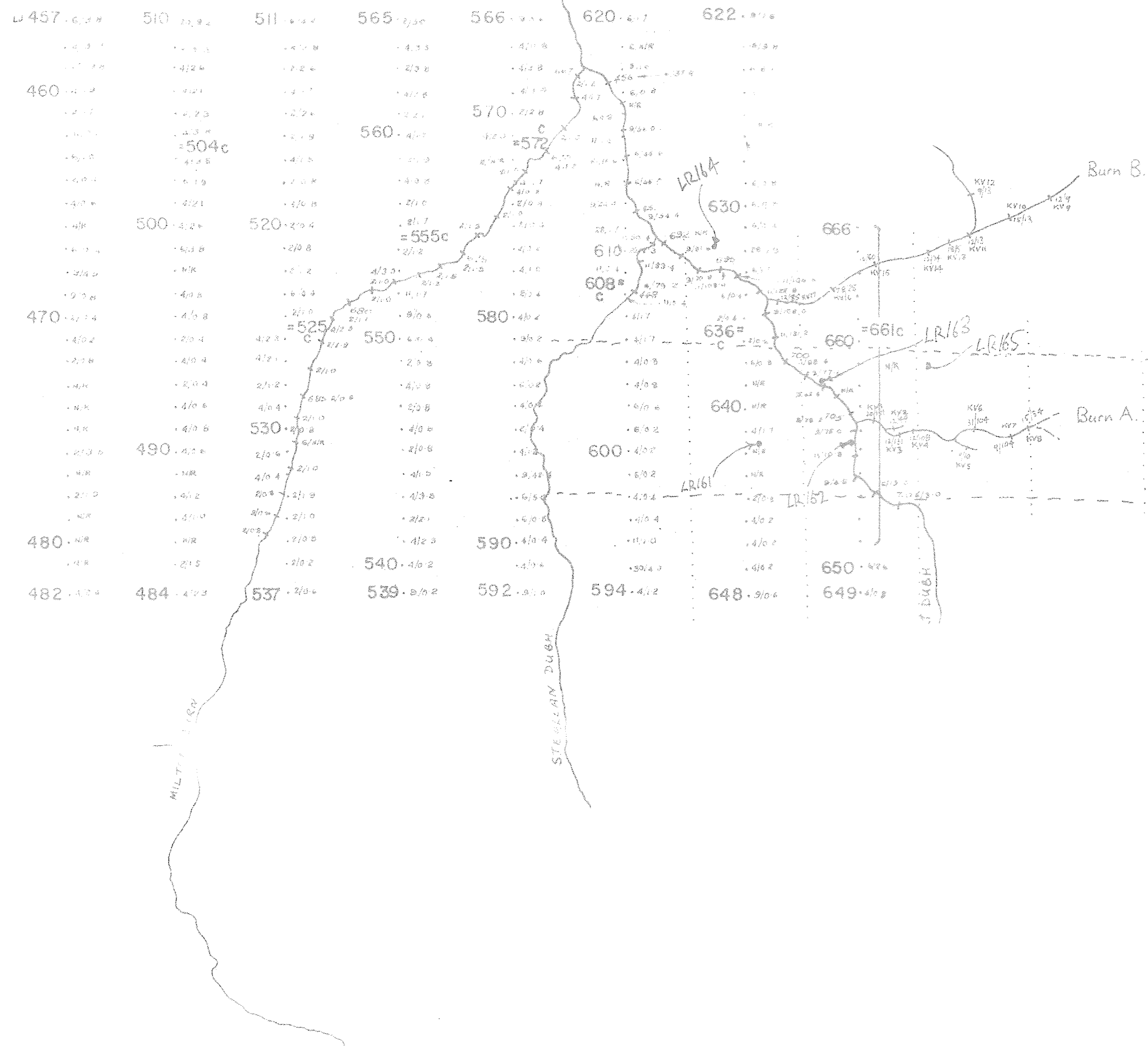

457	510	511	565	566	620	622
460	500	520	560	570	610	630
470	490	530	550	580	600	640
480		540	590	592	594	648
482	484	537	539	592	594	648

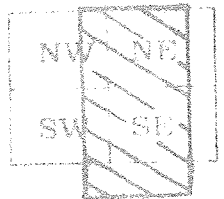

Sheet consists of either
NW & SW or NE & SE

STREAM SAMPLE

Cu Mo

456 SOIL SAMPLE

Edge of peat soil sample locations

Rock Sample positions
Approx. limits of zone
of shearing

Consolidated Gold Fields Limited		ORG. No. 40
Area: AVIEMORE (CLERICH)		
Title: KINVEACHY ESTATE FOLLOW-UP STREAM SAMPLING AND SOIL SAMPLING SAMPLE NOS. LT 557-710 & KV1-17. C.M. No. AE3/40		
O.S. Map No. INVERNESS LVIII		
Scale: 6" to 1 mile	Date: MARCH 1972	
Prepared by: ERP/WFL	Drawn by: B.P.	

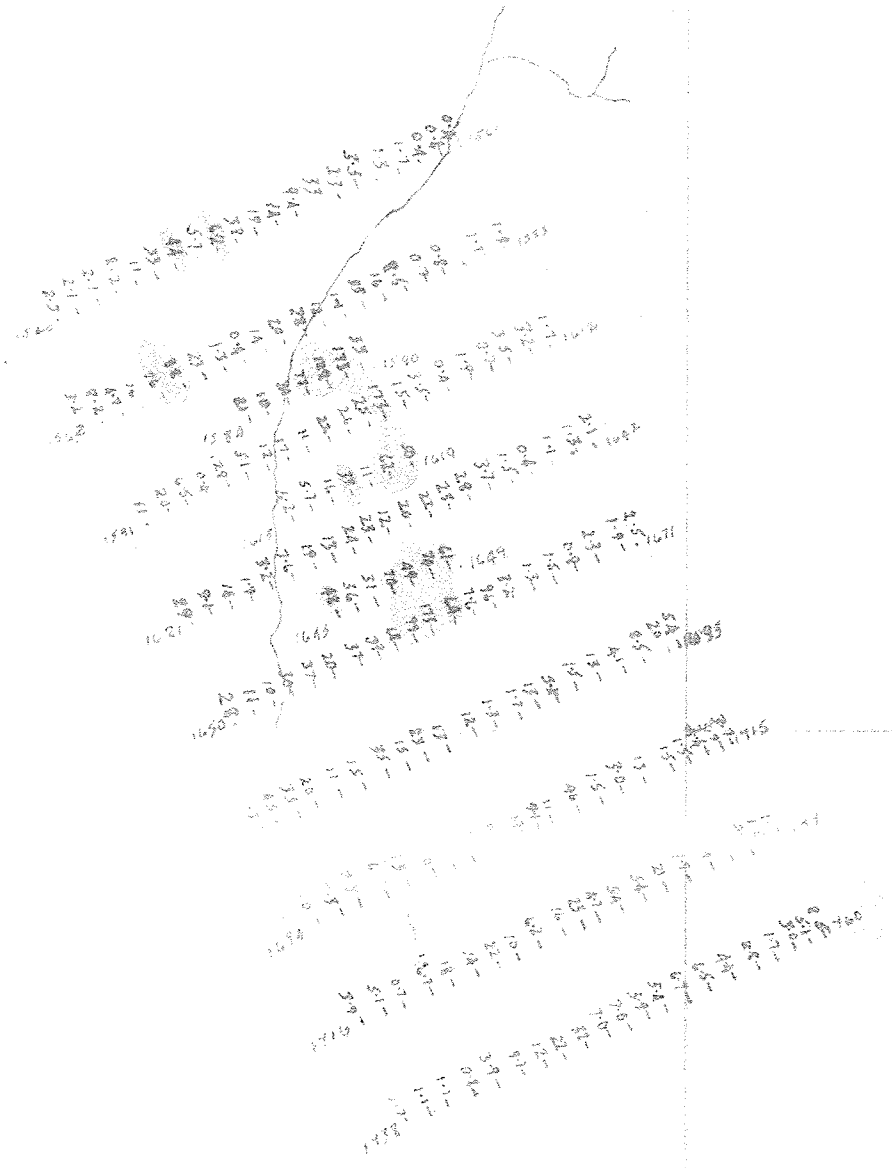

Consolidated Gold Fields Ltd.
EXPLORATION

Project: C.G.F.

Area: AVIEMORE (CLERICH)

Title: ALVIE ANOMALY RECONNAISSANCE
Soil sampling

- 7.3 MOLYBDENUM p.p.m.

AE3/39

Drawing No.	O.S. Map No. NH 81 SW	
	Scale: 1:10,000	Prepared by: E.R.P.
	Date: DEC. 1972	Drawn by: H.G.
Revisions:		

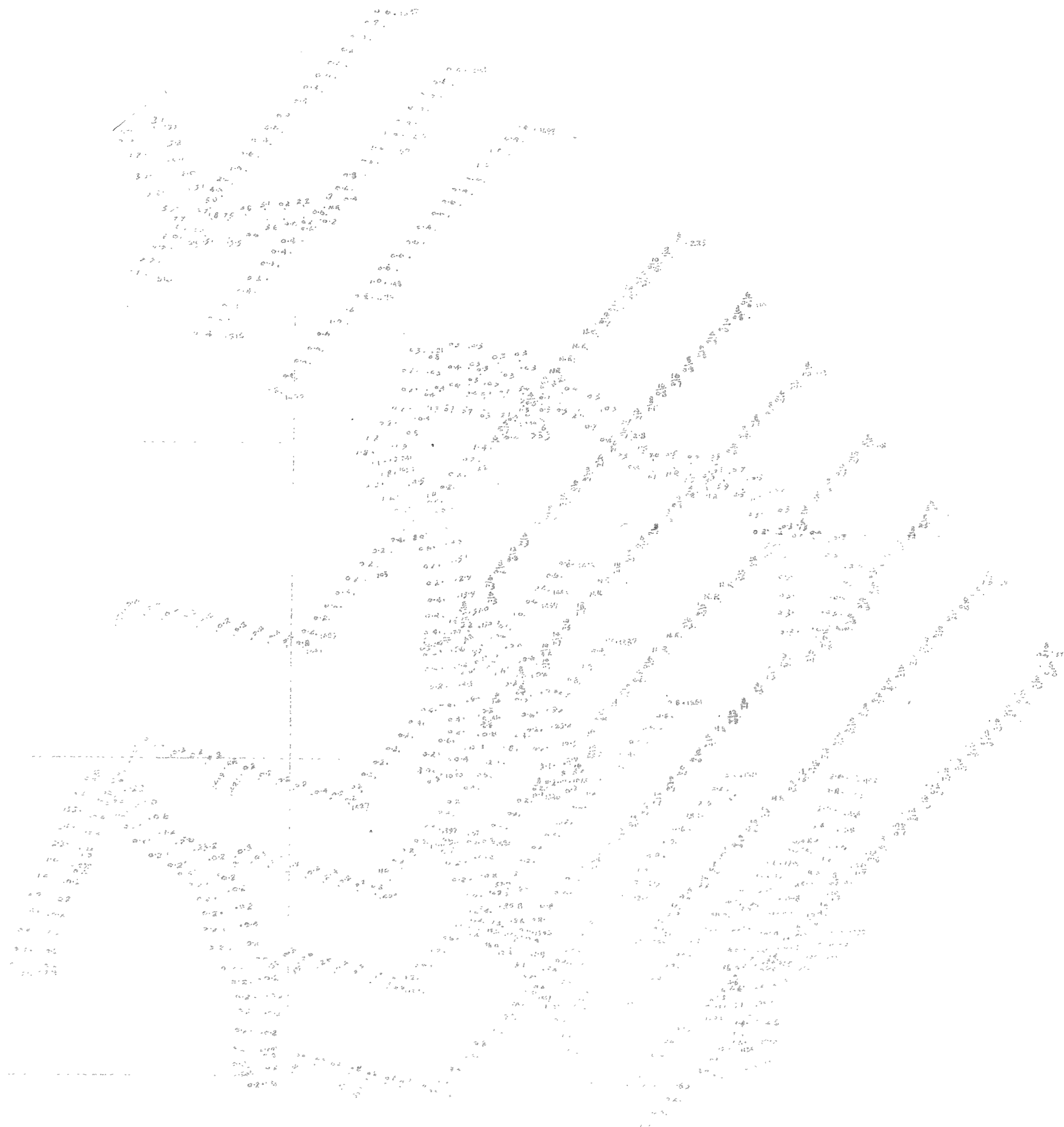

Environmental Lead Levels Map
 10/15/88

Client: Raymond...
 City: AVENMORE (CLERICH) ✓M

Site: Soil Sample Points - ALVIE ESTATE

Values	µMo ppm.
	µCd ppm.
	µHg

AE3/88

Drawn by: [Name] Date: 10/15/88
 Scale: 10,000
 Date: 9/8/82
 Drawn by: ERP
 Date: 4/11/82

- 0-4.9 ppm Mo
- 5-9.9 " "
- 10-19.9 " "
- 20-39.9 " "
- 740 ppm Mo



Consolidated Gold Fields Ltd.		
EXPLORATION		
AVIEMORE	VM	RES/37
Drainage Plan.		
STREAM SEDIMENT RESULTS <u>Copper</u> <u>Niobdenium</u>		
DR. N°	28, 29, 37, 38	Prepared by J.A.
	Geological Map N°	J.A. B.P.
37	Scale 1" to 1 mile	Date Feb. 1942
Revised by		

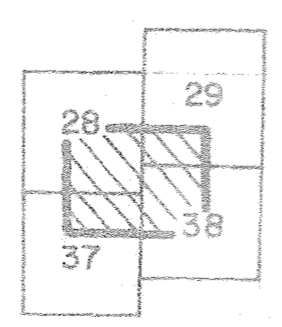



MULLACH NAN COIREAN

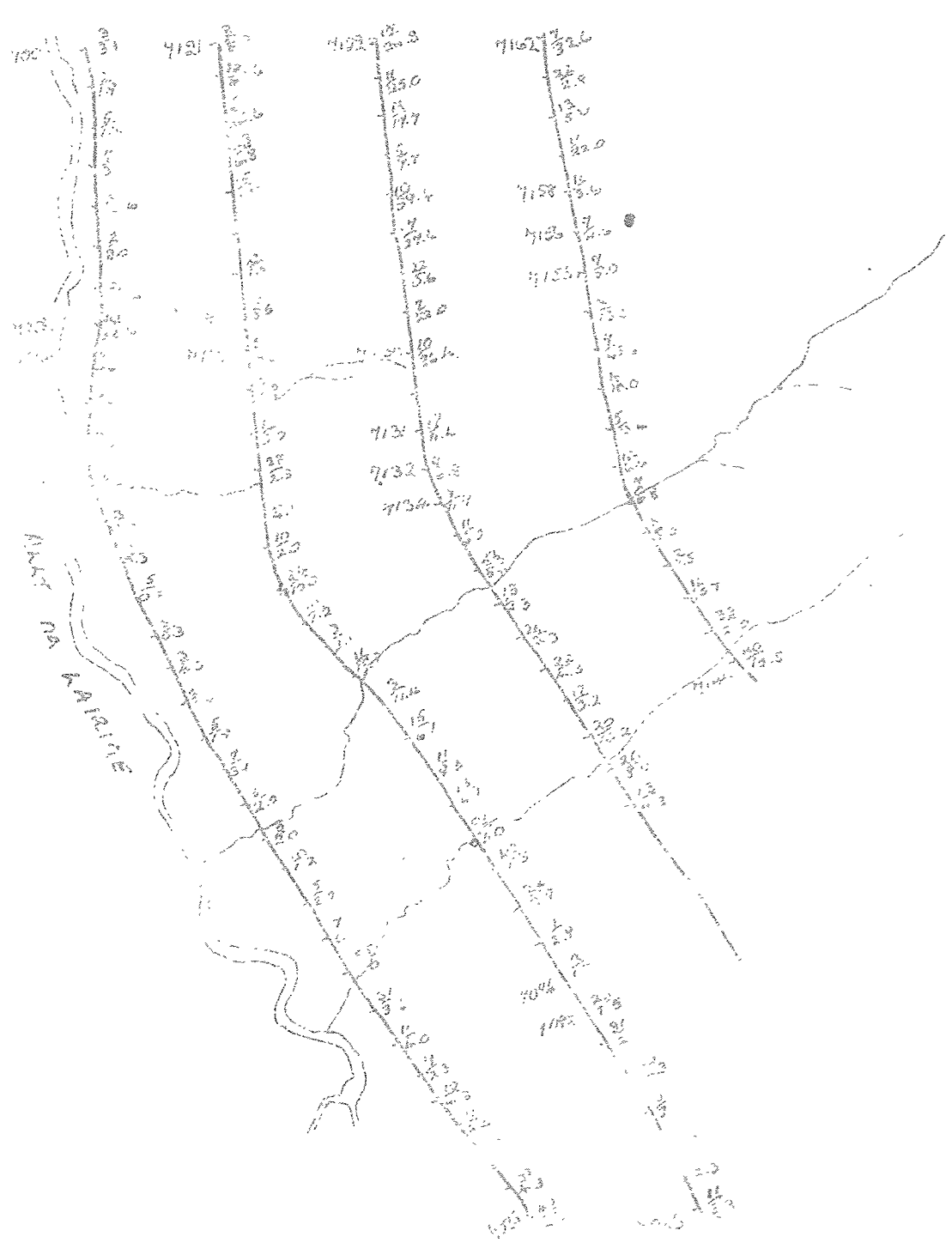

Consolidated Coal Fields Ltd.
EXPLORATION

T1. MULLACH - NAN - COIREAN AREA.
SOIL SAMPLING RESULTS.

VALUES IN PPM.

AE3/36

DIR N	INVERNESS CLX, CLXVI	DIR N	ERP
36	Geological Map No -	ATW	
	Scale 6" to 1 mile	DATE	FEBRUARY 1952

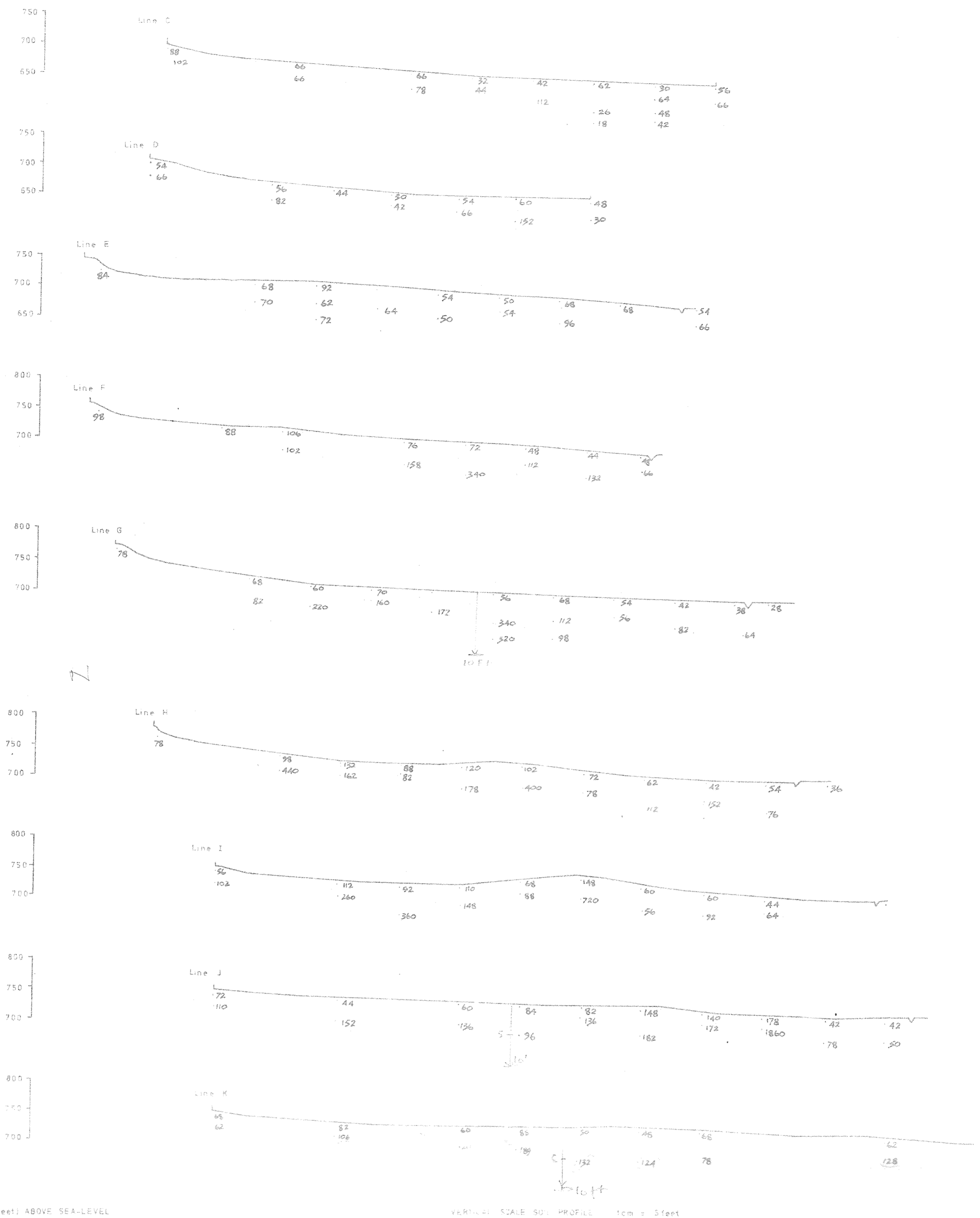

Consolidated Gold Fields Ltd.
EXPLORATION

Project: LAKE DISTRICT - COCKERMOUTH
 Area: Torpenhow Anomaly
 Title: SECTIONS - Lines C - K
 Copper (Cu) p.p.m.

AE3/19

Drawing No.	C/S Map No. Cambridge XLVI 3
Scale: 2cm = 100'	Prepared by: E.R.P.
Date: Oct 1972	Drawn by: A.T.W.
Revisions:	



Consolidated Gold Fields Ltd.	
EXPLORATION	
COMMERCIAL - IN CONFIDENCE	
Foot: Cu, Ni, Mo.	
Site: DALBEATTIE AREA.	
Title: Stream sediment results - CUSHAT WOOD and AIRDRIE FARM AE3/33	
Sample numbers: LD 1201 - 1270	
Drawing No.	O.S. Map No. NX 96 SE 95 NE
Scale: 6" to 1 mile	Prepared by: G.L.P.
Date: May 1972	Drawn by: A.T.W.
Revisions:	

✓ Cu Ni
Zn

STREAM SEDIMENT SAMPLE
VALUES Cu, Pb ppm.
Zn

33

COMMERCIAL IN CONFIDENCE



87

88

Consolidated Gold Fields Ltd.
EXPLORATION

TITLE: DALBEATTIE AREA.
Soil sampling, COLVEND (11/11/60) Cu ppm * Sample No
Sample numbers, LD 2170-2191

AE3/32

32

Dwg. No.	G.S. MAP No. NX 85 SE 6 ⁿ	Prepared by G.L.P.
	Geological Map No. -	Drawn by B.P.
	Scale 1:2500	Date Apr. - 1962
Revisions		

1. The first section contains several lines of text, possibly a title or header, which are mostly illegible due to the angle and fading.

2. The second section contains a list of items or a table with multiple columns, also mostly illegible.

3. The third section contains a few lines of text, possibly a signature or a date.

Consolidated Gold Fields Limited		Ref. No.
		21
Date		
Scale		
Prepared by		

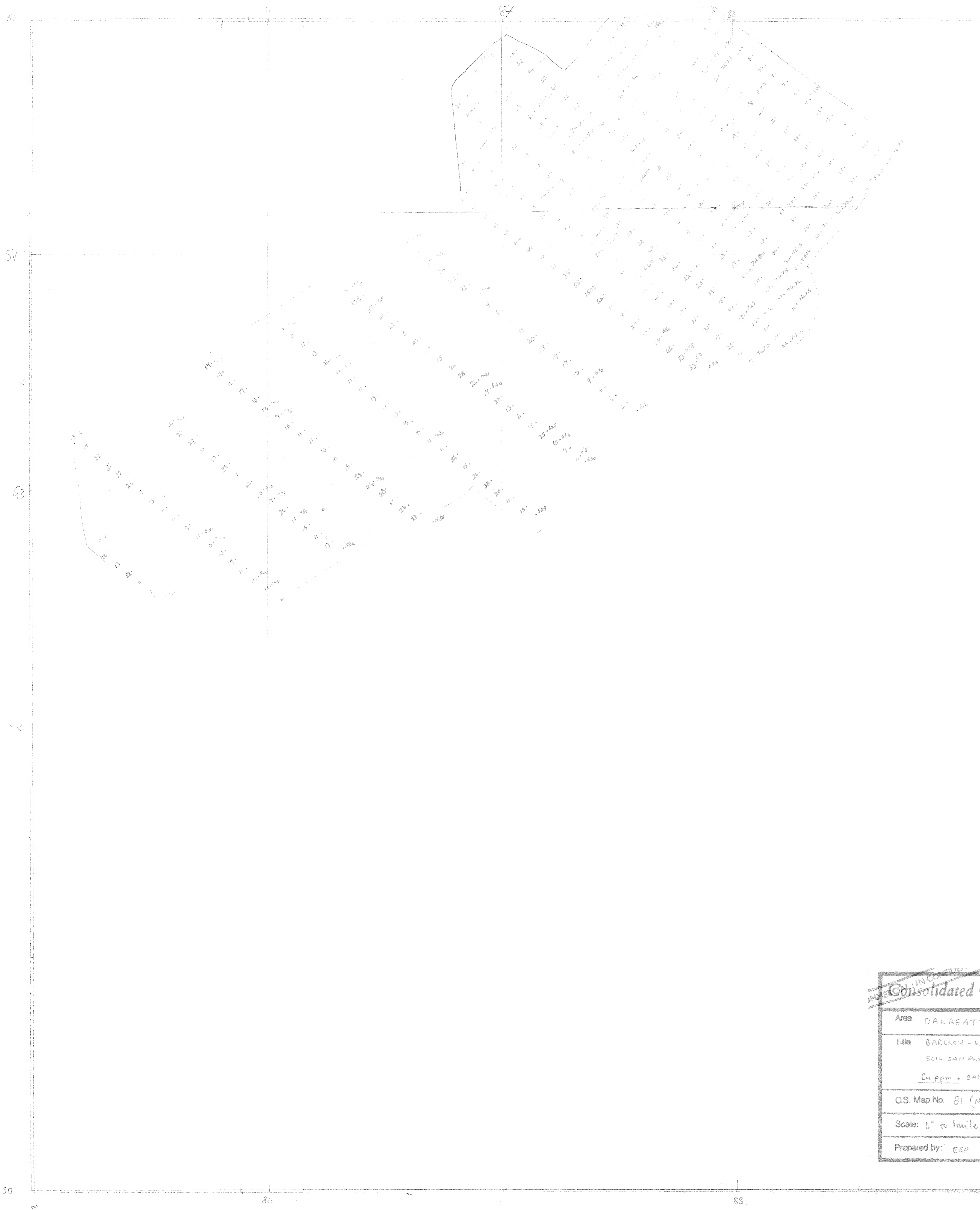

IN CONFIDENTIAL		DRG No.
Consolidated Gold Fields Limited		30
Area: DALBEATTIE		
Title: BARCLOY - WHITE HILLS SOIL SAMPLING		
Cu ppm - SAMPLES		AE3/30
OS Map No. 81 (NX 85SE)		
Scale: 6" to 1 mile	Date: DECEMBER 1971	
Prepared by: ERP	Drawn by: GA	

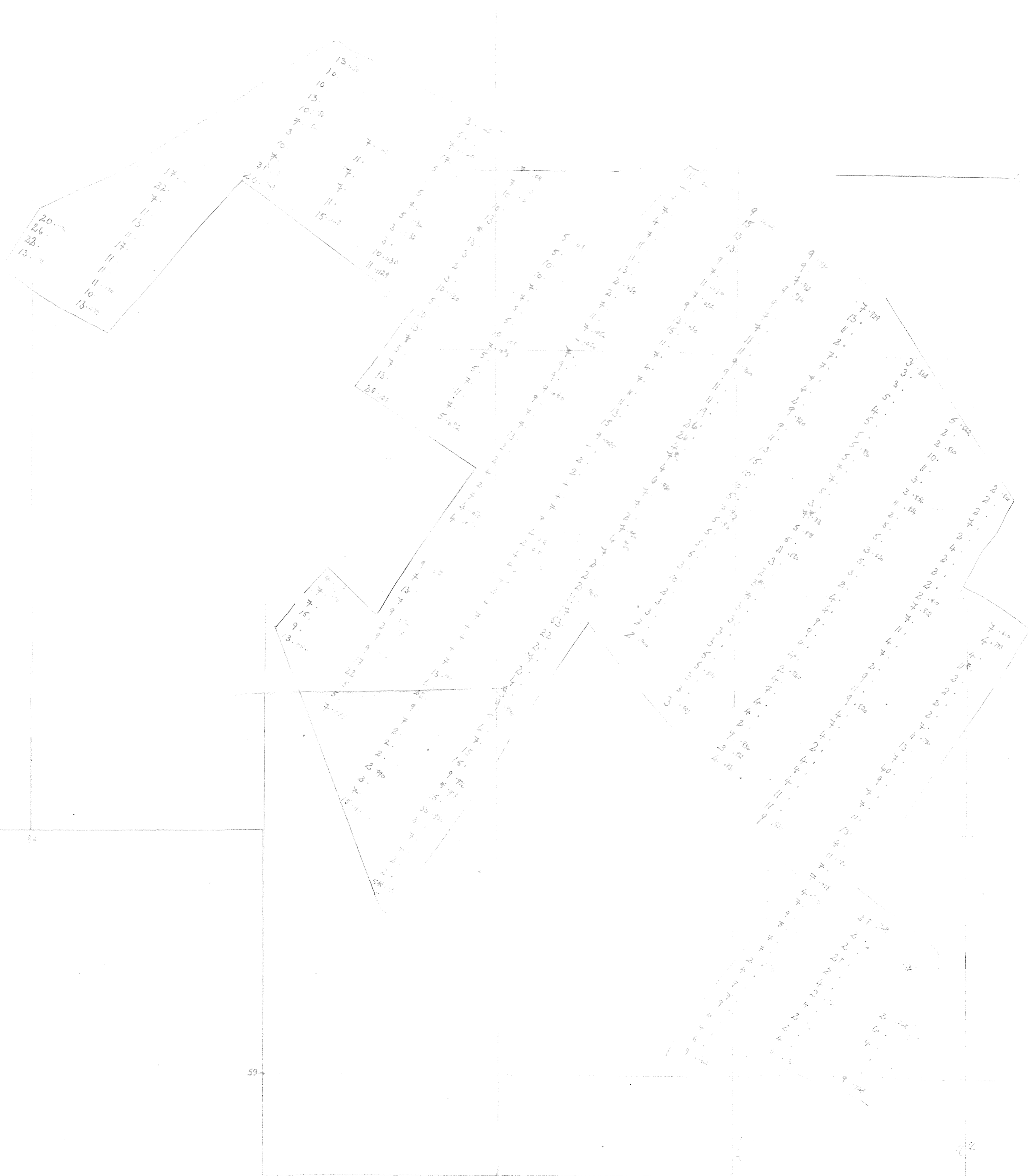

Consolidated Gold Fields Ltd.
EXPLORATION

Site: DALBEATTIE AREA
BARCLOSH HILL
SOIL SAMPLING RESULTS
Copper ppm. SAMPLE NO. **AE3/28**

Drwg. No.	O.S. MAP NO. NX 86SE, SW	Prepared by	ERP
28	Geological Map No.	Drawn by	GM
	Scale 6" to 1 mile	Date	DECEMBER 1971
	Revisions		



Consolidated Gold Fields Ltd.
EXPLORATION

Title DALBEATTIE AREA
BARCLOSH HILL
SOIL SAMPLING RESULTS
MOLYBDENUM ppm. SAMPLE NO. **AE3/27**

Dwg. No. 27	O.S. MAP No. NX 86 SE, 94	Prepared by ERP
	Geological Map No.	Drawn by GN
	Scale 6" to 1 mile	Date DECEMBER 1971
Revisions		

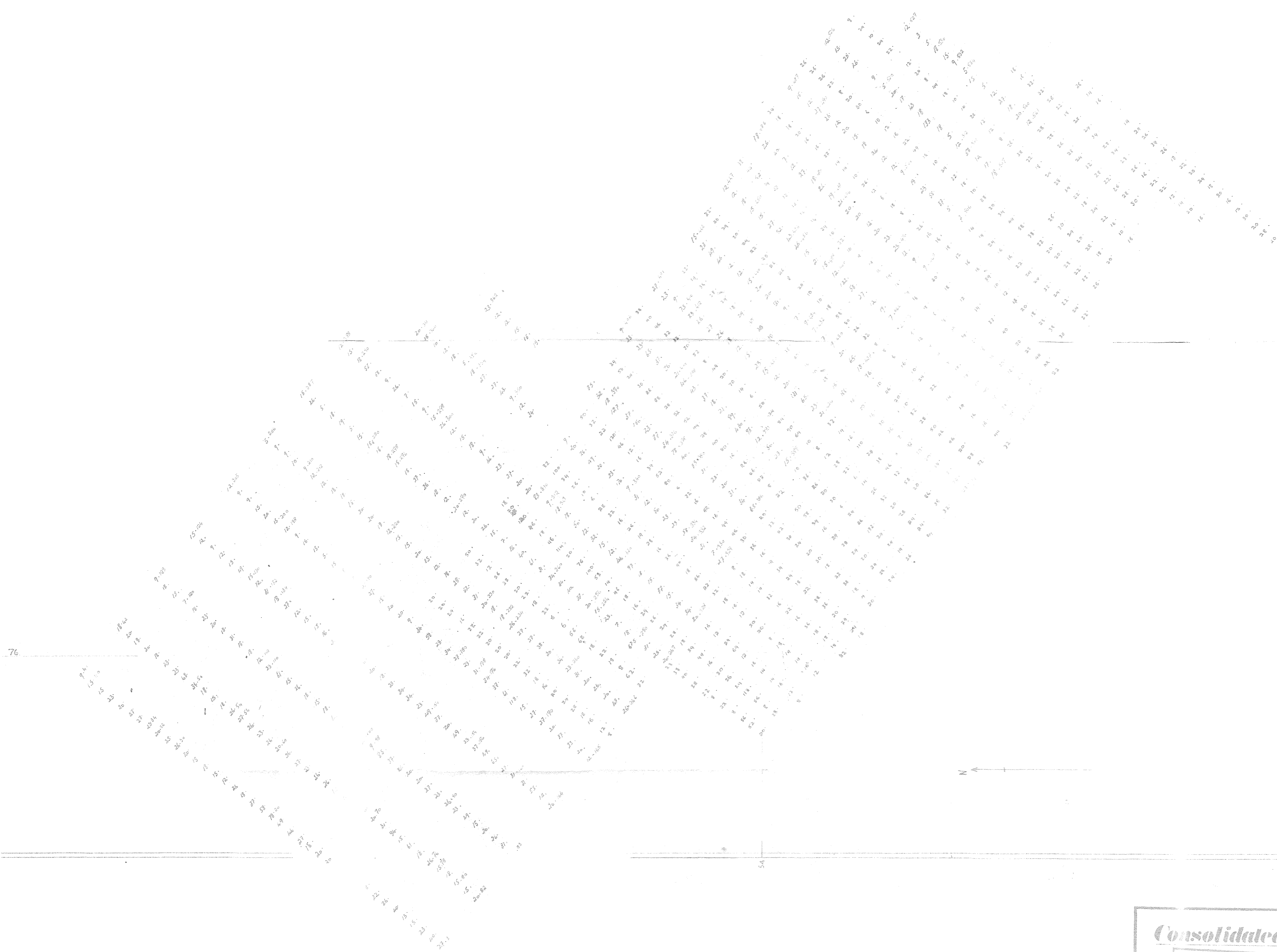

76

Consolidated Gold Fields Ltd.		
COMMERCIAL IN CONFIDENCE EXPLORATION		
THE DALBEATTIE AREA - ARELAND MOOR.		
SOIL SAMPLING RESULTS.		
COPPER P.P.M. - SAMPLE NO.		
AE3/26		
Dig No. <input checked="" type="checkbox"/> 26	Geological Map No. NX75NE, 75SE	Prepared by - E.A.P.
	Geological Map No.	Drawn by - G.M.
	Scale 6" to 1 mile	Date - DECEMBER 1977
	Revisions	WELL LOGS SEE PAGE 172

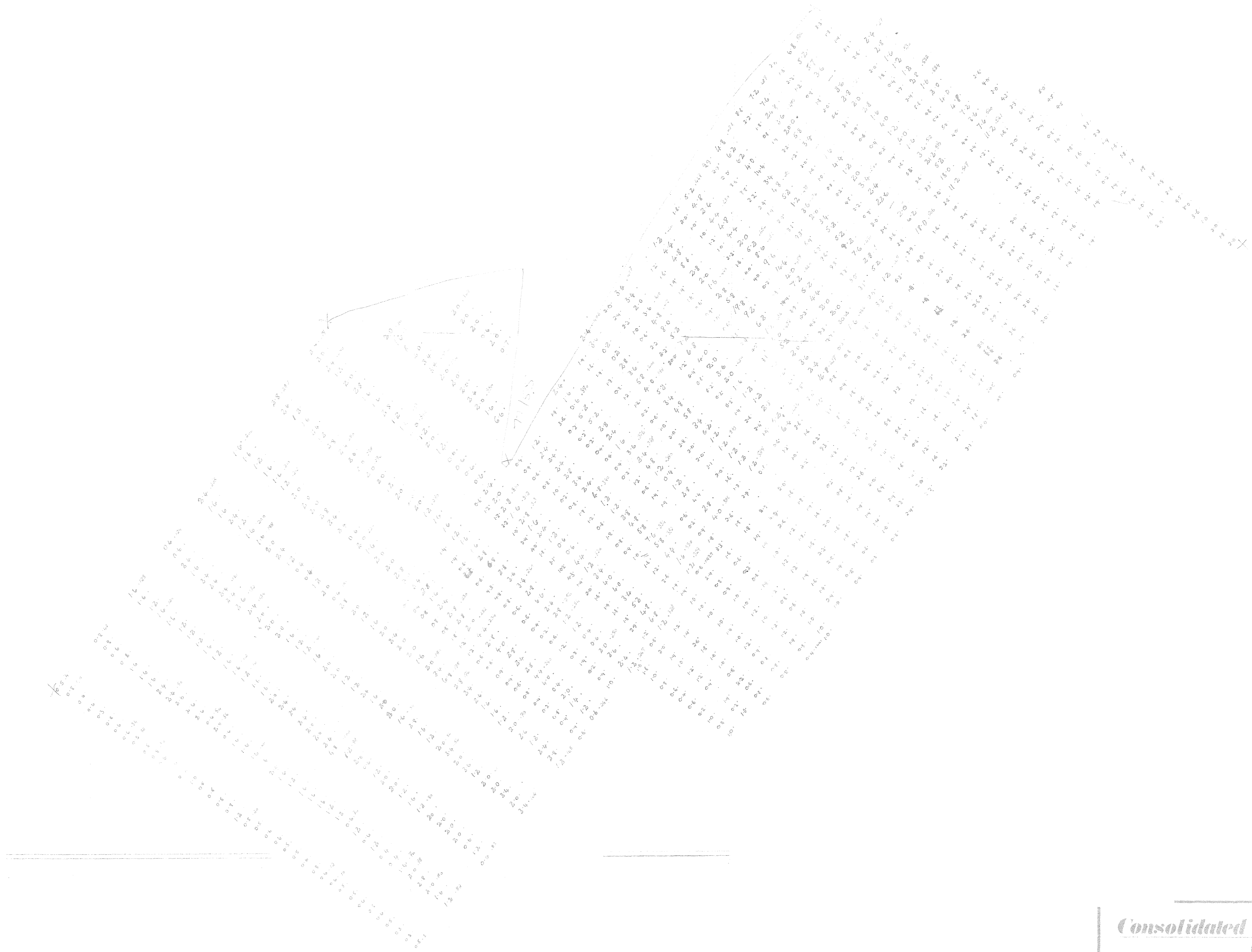

Consolidated Gold Fields Ltd.
EXPLORATION

FILE: DALBEATTIE AREA - AIRELAND MOOR
SOIL SAMPLING RESULTS.
POLYADENUM ppm. & SAMPLE NO.

AE3/25

COMMERCIAL IN CONFIDENCE

Drg. No. 25 ✓	D.S. MAP N. NRTS NE/SE	Prepared by: EAP
	Geological Map No.	Drawn by: GM
	Scale: 6" to 1 mile	Date: DECEMBER 1971
	Revisions:	WAP 2105; GAZ. 10/1/72



Consolidated Gold Fields Ltd.

SCOTTISH EXPLORATION

COMMERCIAL IN CONFIDENCE

Field Office: "Little Dugh", Ruthven, Cairn Robin, Puirly, Aberdeenshire

Number Sequence: $\frac{\text{ppm Copper}}{\text{ppm Mo/ly/bdenum}}$ / $\frac{\text{ppm Tin}}{\text{ppm Tungsten}}$
 Sample Numbers LSI-399 & LS 671-675

AE3/24

Scale: 1 inch to 1 mile

Date 10th June 1971

Drawn C.P.R.

Overlay to be read with G.S. Sheet N9 61.

COMMERCIAL IN CONFIDENCE

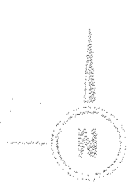

40	45	95	60	55	40	20	100	80	70										
40	55	40	40	125	50				95										
50	50	50	50	50	375	25	10	1200	115	100	100	100							
20	45	45	85	525	375	40	80	1200	30	80	130								
15	60	70	50	45	45	25	80	855	840	25	100								
30	70	70	75	75	50	90	100	1200	270	100	100								
20	40	90	40	40	35	320	30	10	495	50	50								
35	50	75	50	50	50	15	100	70	20	40	100								
65	45	525	50	50	875	40	120	85	25	80	100								
70	90	60	40	50	90	165	100	80	25	50	100								
70	115	70	40	40	50	160	50	40	60	50	60								
65	115	100	60	80	125	190	20	20	70	35	45								
50	115	100	40	00	50	00	140	65	50	50	147	50							
40	65	230	90	40	65	525	40	80	60	60	60	85							
40	75	110	100	120	60	525	375	115	80	95	100	100							
15	65	115	80		75	20	825	100	80	150	90	90							
35	65	100	80	90	525	50	425	40	80	110	125	95							
30	75	90	110	80	80	45	575	75	80	105	160	310	45	55					
55	170	1275	80	50	925	25	80	145	95	120	105	160	310	45	55				
50	90	525	80	90	80	25	825	73	100	110	210	107	55	125	360	270	20	45	
05	80	575	120	120	85	47	90	110	110	110	110	110	185	155	155				
25	70	325	80	80	160	75	100	100	180	85	121	170	145	145					
40	60	525	60	60	110	50	825	112	120	110	30	30	717	53					
15	50	575	70	70	80	60	975	92	117	125	467	467	53	53					
05	45	75	60	60	100	100	1125	113	151	151	41740	60	70	70					
30	75	1000	50	50	100	90	1025	113	95	33	33	55	55						
15	70	110	60	60	220	40	1225	175	20	47	47	70	70						
10	65	1275	60	60	80	80	1105	100	30	30	30	30	30						
30	95	100	50	50	90	80	95	115	100	160	160	30	30						
65	60	135			40	120	120	120	30	30	30	30	30						
60	175	115			40	40	40	40	30	30	30	30	30						
65	70	75			30	30	30	30	30	30	30	30	30						
30	100	50			30	30	30	30	30	30	30	30	30						
65	55	375			38	58	53	53	53	53	53	53	53						
25	50	675			30	30	30	30	30	30	30	30	30						
50	40	50			30	30	30	30	30	30	30	30	30						
65	35	35			30	30	30	30	30	30	30	30	30						
	60	10			30	30	30	30	30	30	30	30	30						
	40	45			30	30	30	30	30	30	30	30	30						
	100				30	30	30	30	30	30	30	30	30						
	120				30	30	30	30	30	30	30	30	30						
	80				30	30	30	30	30	30	30	30	30						
	80				30	30	30	30	30	30	30	30	30						

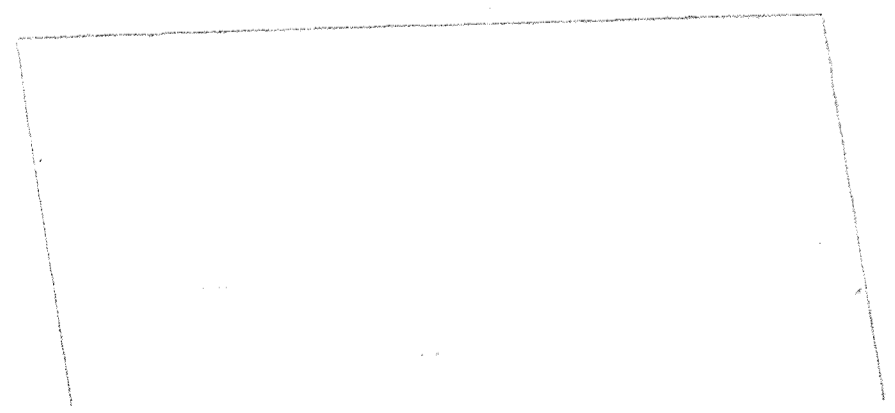

Consolidated Gold Fields Ltd.	
EXPLORATION	
Project:	
Area: LAKE DISTRICT - COCKERMOUTH	
Title: TORPENHOW ANOMALY - DETAILED W. CHARGEABILITY - M. SECS.	
DIPOLÉ - DIPOLÉ N=2 (100' AE3/22	
Drawing No.	G.S. Map No. COMBERLAND XXXVI 15 XLVII 3 XXXVI 16 XLVI 4
Scale: 2.5" = 1 MILE	Prepared by: ERP
Date: OCT 1972	Drawn by: IR
	then extended to south Dec. 1972

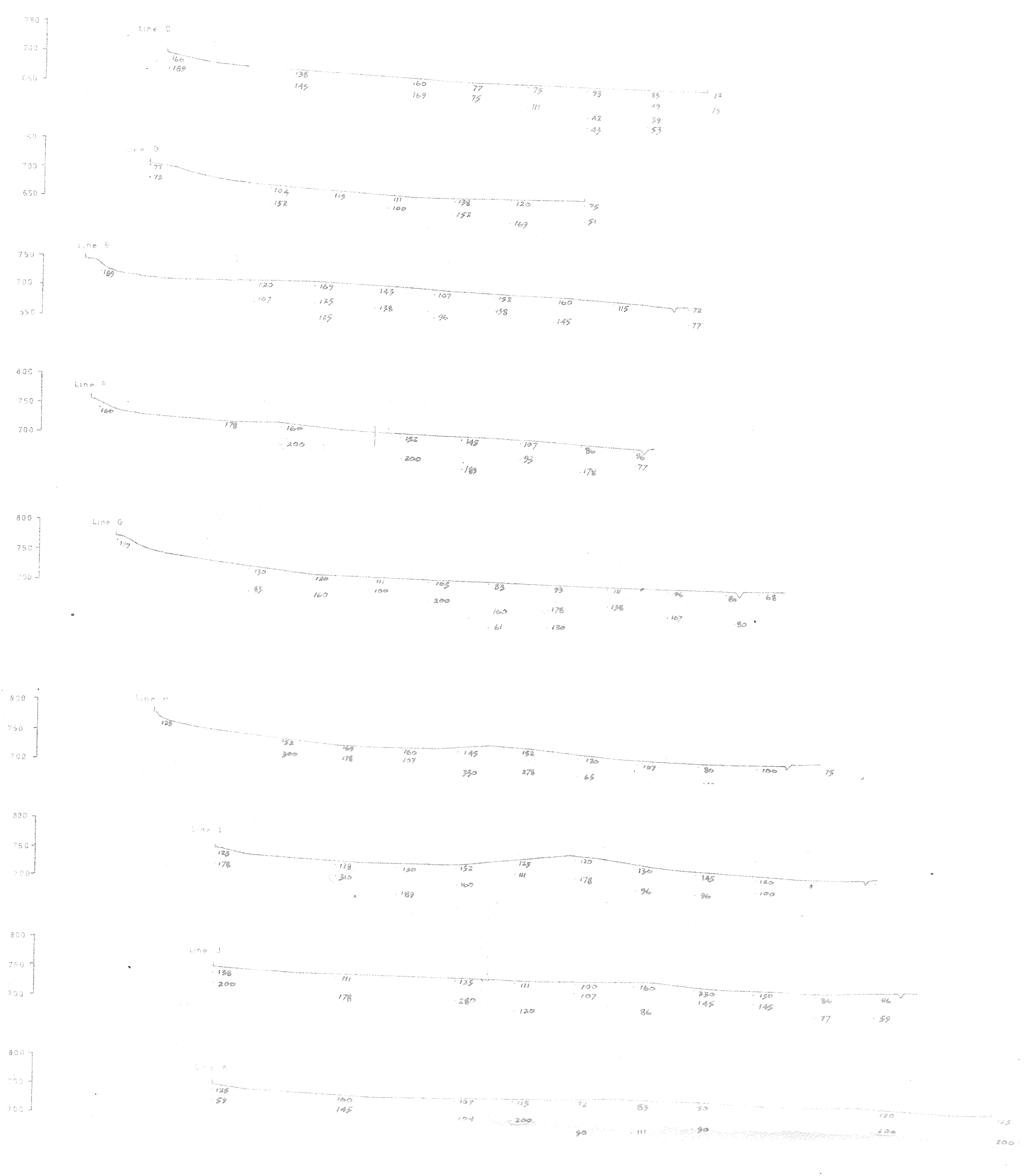

HEIGHT (in feet) ABOVE SEA-LEVEL

VERTICAL SCALE: SOIL PROFILE 1cm = 5feet

Consolidated Gold Fields Ltd.	
EXPLORATION	
Project:	LAKE DISTRICT - COCKEELMOUTH
Area:	Torpenhow Anomaly
Title:	SECTIONS — Lines C — K
	Zinc (Zn) p.p.m.
	AE3/21
Drawing No.	O.S. Map No. Cumberland XLVI 3
Scale:	2 cm = 100'
Date:	Oct 19/2
Revisions:	Prepared by: ERP Drawn by: A.T.W.

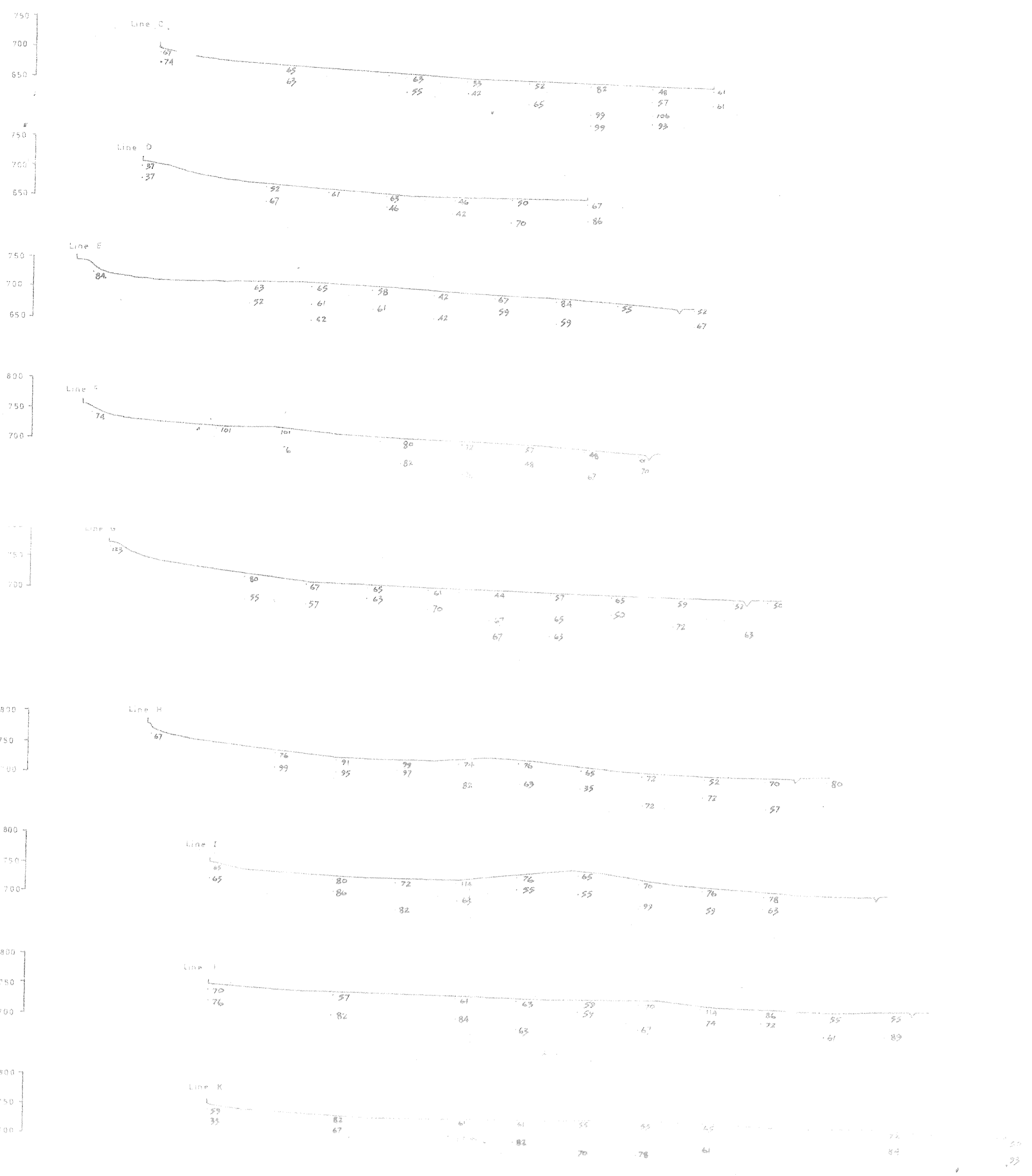

Consolidated Gold Fields Ltd.	
EXPLORATION	
Project:	LAKES DISTRICT - COCKERMOUTH
Area:	Torpenhow Anomaly
Title:	SECTIONS - Lines C - K
	Lead (Pb) p.p.m.
	AE3/20
Drawing No.	O.S. Map No. Cumberland XLVI 3
	Scale: 2cm = 100'
	Prepared by: E.R.P.
	Date: Oct. 1972
	Drawn by: A.T.W.
Revisions:	



COMMERCIAL: IN CONFIDENCE

Consolidated Gold Fields Ltd.
SCOTTISH EXPLORATION

Number Sequence ppmCopper / ppmTin
ppmMolybdenum / ppmTungsten
Sample Numbers LS 401-659

Scale: 1 inch to 1 mile
Date 9th June 1971
Drawn C.P.R.

AES/1

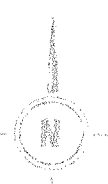

Overlay to be read with G.S. Sheet N9 60.



Consolidated Gold Fields Ltd.
EXPLORATION

LAKE DISTRICT
COCKERMOUTH - Torpenhow Area
PIT PROFILES AND GEOCHEMICAL PROFILES

AE3/17

17	Geological Map No.	NY 13 NE NY 23 NW	Prepared by	GLP
	Scale	6" = 1 mile	Drawn by	ATW.
	Date	30 May 1952		
	Revisions			



Consolidated Gold Fields Ltd.	
EXPLORATION	
Project	Cu, Ni, Mo
Area	LAKE DISTRICT - COCKERMOUTH
Title	TORPENHOW ANOMALY DETAILED SOIL PROFILE SAMPLING AE3/18
	• Cu, Pb, Zn TOP SAMPLE • Cu, Pb, Zn BOTTOM SAMPLE
Drawing No.	U.S. Map No. Cumber and XXXVI 11 XLVI 3, XXXVI 15 XLVI 4
	Scale 207 10 1976 Preparation ERP
	Date Oct 1976 Drawn by ATW
	Revised

COMMERCIAL: IN CONFIDENCE

NORTH LAKE DISTRICT

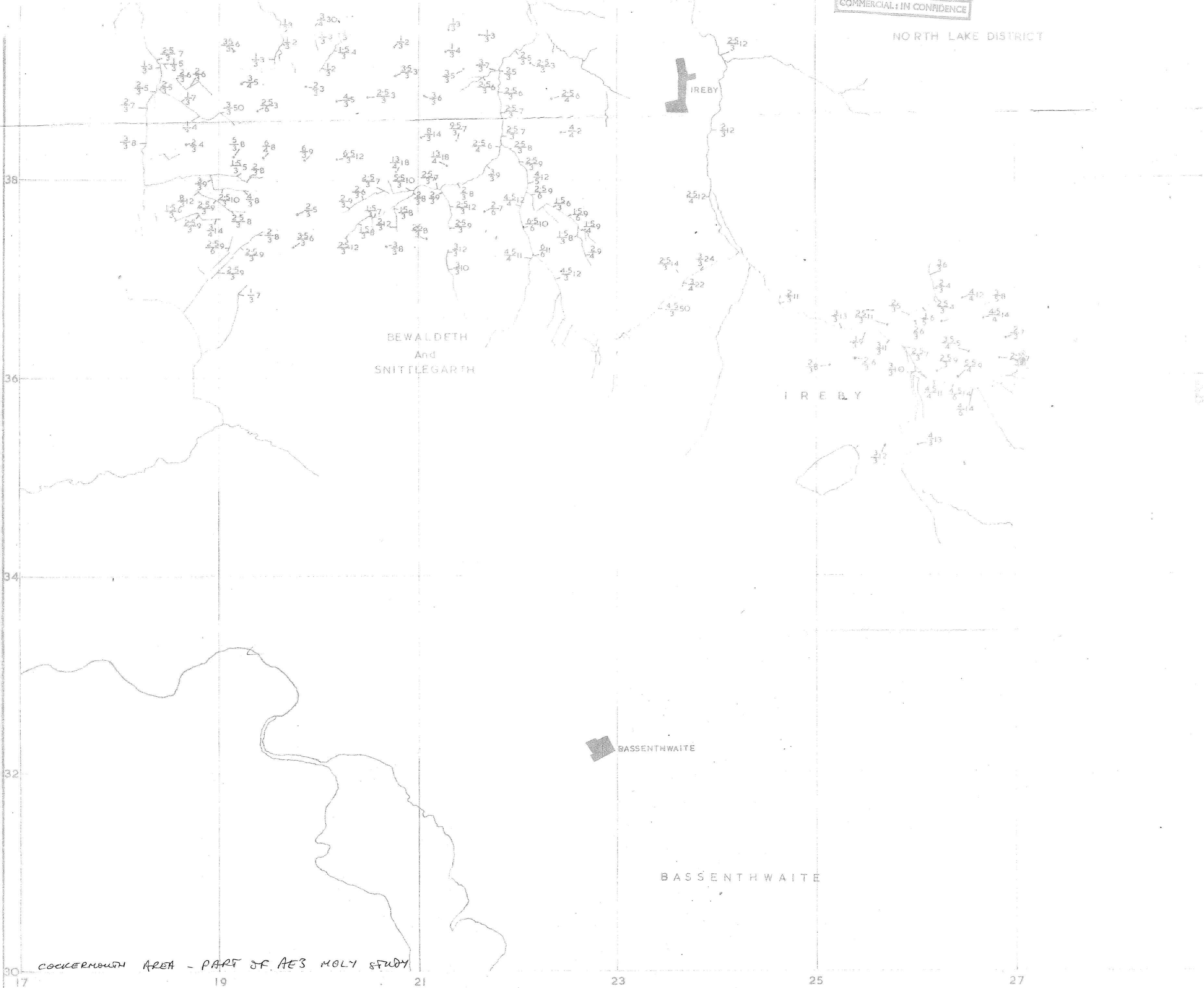

COCKERMOUTH AREA - PART OF A.E.3 MOLY STUDY

CONSOLIDATED GOLD FIELDS LTD.

SCOTTISH EXPLORATION

AE3/11

Field Office: "Little Dough" Ruthven, N. Huntly, Aberdeenshire.

Samples BR16 to BR179
 Number Sequence
 eg $\frac{35}{3} 60 = \frac{35 \text{ppm Cu}}{30 \text{ppm Pb}} 60 \text{ppm Zn}$

Copper	Zinc x10
Lead	
NY13	NY23

O.S. Sheets on this overlay.

Scale: 2 1/2 inches to 1 mile.

Date: 21st. May 1971

Drawn C.P.R.

Overlay to be read with O.S. Sheet No. NY13 & 23

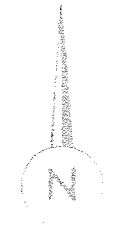

7100

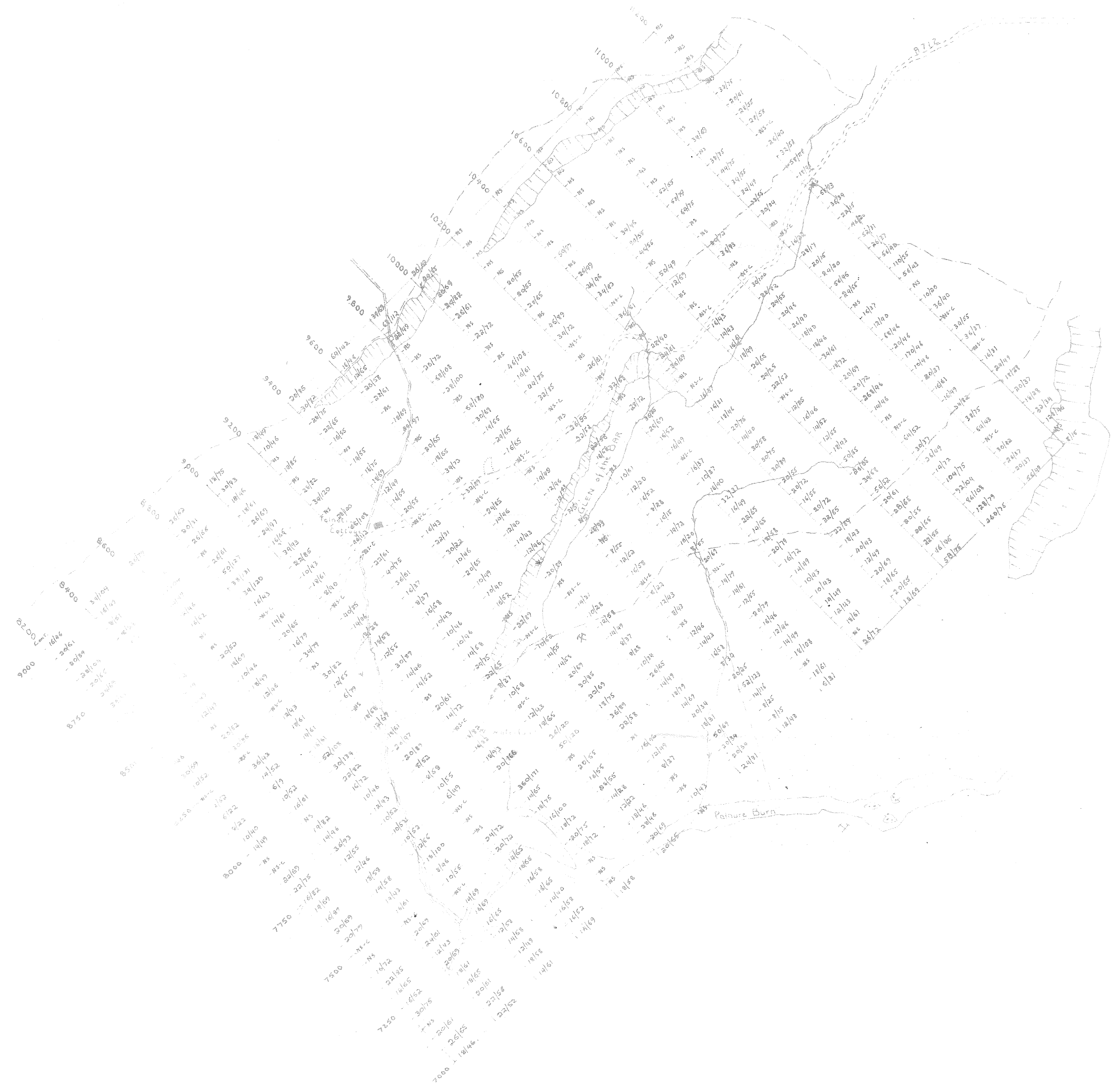

RAE PLAN
 DETAIL SOIL SAMPLING

NS - No SAMPLE
 NS-C - CONTROL
 - Cu - No ppm

OS MAP No. _____
 SCALE _____ DRAWN BY G.P.
 DATE _____ 197 _____ CHECKED BY G.P.

AE3/9



Consolidated Gold Fields Ltd.

SCOTTISH EXPLORATION

Title:

TALNOTRY - MAGNETOMETRY
 VERTICAL MAGNETIC INTENSITY IN GAMMAS⁺

AE3 (8)

⁺ LOCAL ARBITRARY BASE

Drg. No 8	O.S. MAP No NX47SE, NX57W, 10465E	Prepared by G L P		
	Geological Map No	Drawn by B P S C		
	Scale 6" to 1 mile	Date Jan - 21 1972		
Revisions	<table border="1" style="width: 100%; height: 20px;"> <tr> <td style="width: 50%;"></td> <td style="width: 50%;"></td> </tr> </table>			

LOCATION



73

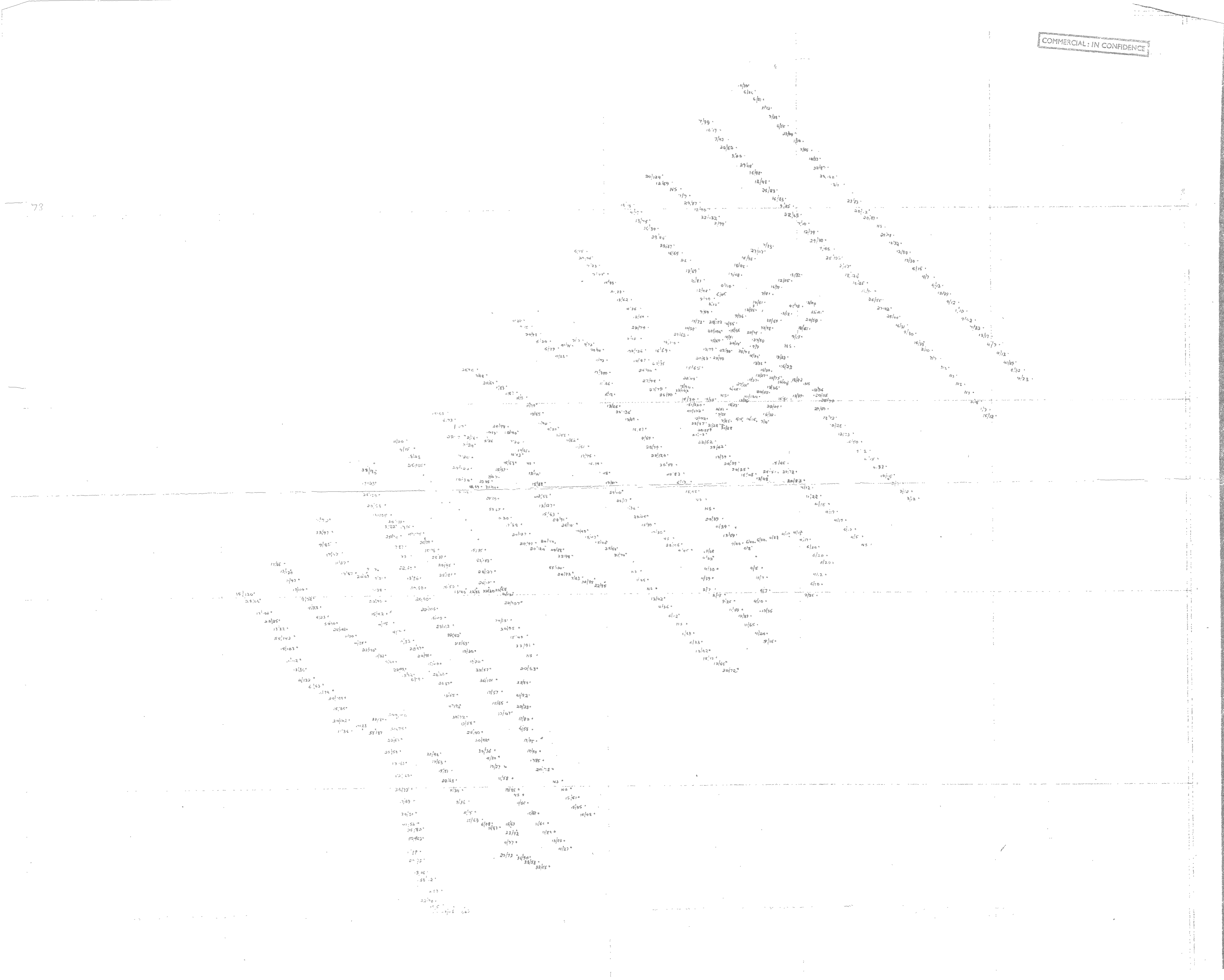

Consolidated Gold Fields Ltd.							
SCOTTISH EXPLORATION							
TALNOTRY AREA							
RECCE SOIL SAMPLING - LC							
Values in ppm Cu/Ni ✓							
AE3/7							
7	<table border="1"> <tr> <td>NY 97 SE 87 SW A 6 NE</td> <td>Prepared by G.L.P.</td> </tr> <tr> <td>Geological Map No 4 + B</td> <td>Drawn by G.L.P.</td> </tr> <tr> <td>Scale 6 inch = 1 mile</td> <td>Date 6th April 1972</td> </tr> </table>	NY 97 SE 87 SW A 6 NE	Prepared by G.L.P.	Geological Map No 4 + B	Drawn by G.L.P.	Scale 6 inch = 1 mile	Date 6th April 1972
NY 97 SE 87 SW A 6 NE	Prepared by G.L.P.						
Geological Map No 4 + B	Drawn by G.L.P.						
Scale 6 inch = 1 mile	Date 6th April 1972						

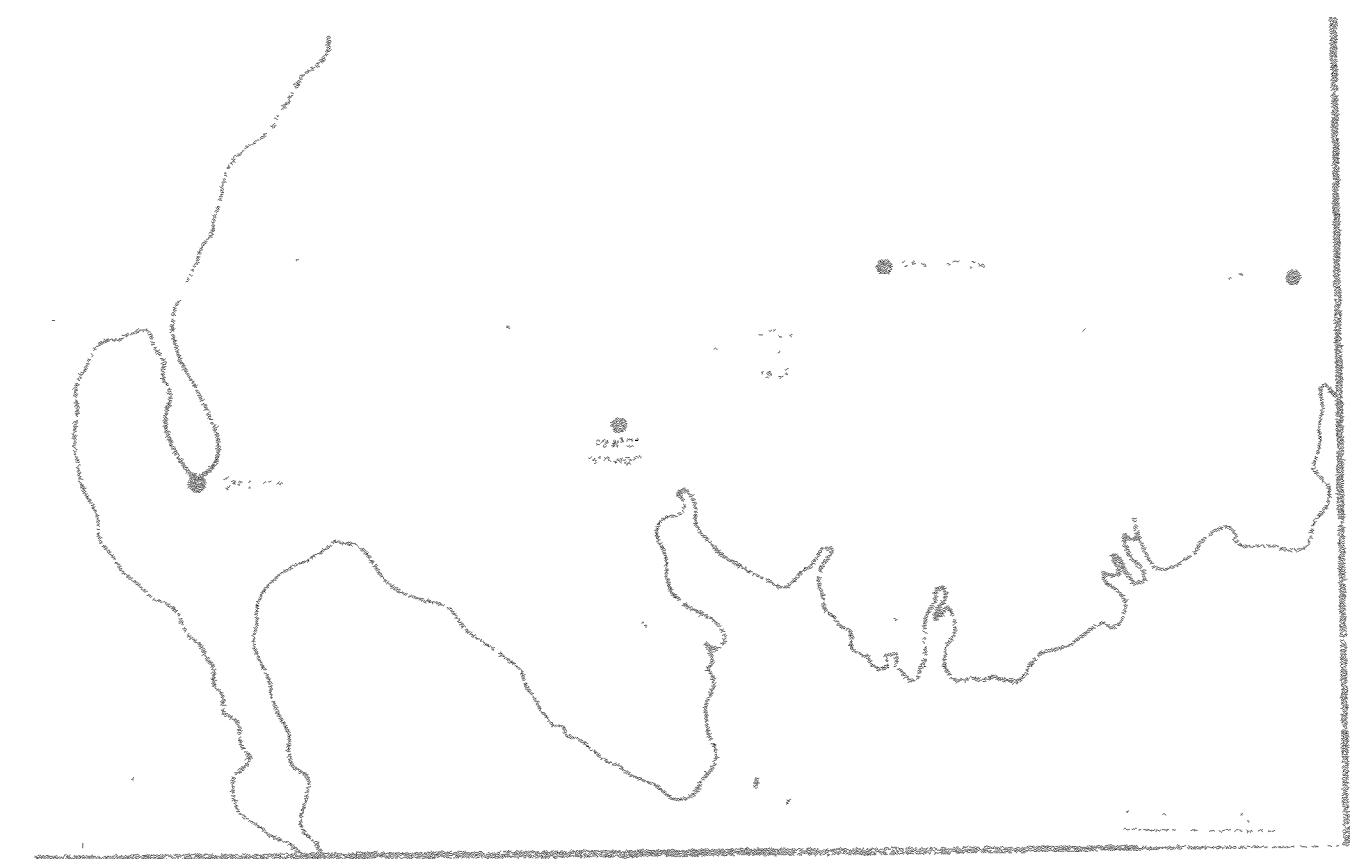

COMMERCIAL: IN CONFIDENCE



Consolidated Gold Fields Limited		ORG. No 6
Area: TALNOTRY MO AREAS		✓
Title: CRAIGLOWRIE HILL SOIL SAMPLING RESULTS • C/MO PPM		AE3/6
Q.S. Map No. NX 56 NW, NE		
Scale: 6" to 1 mile	Date: AUGUST 1973	
Prepared by: ERP	Drawn by: ATW	

Ⓞ Areas sampled after June 1973 1972 — checked with M.F. Jones
 & CBF on 5.7.74



Consolidated Gold Fields Ltd.
EXPLORATION

TALNOY Mo AREAS **Loch Ken**

Soil Sampling 4.8 ppm Mo

AE3/5

Map No.	605/100 N157 SW	Prepared by	AGL
	1:50,000 Map of S	Scale	1:50,000
	Sheet 5 - 1000	Date	1977

- 0-4.9 ppm Mo
- 5-9.9 " "
- 10-19.9 " "
- 20-39.9 " "
- >40 ppm Mo

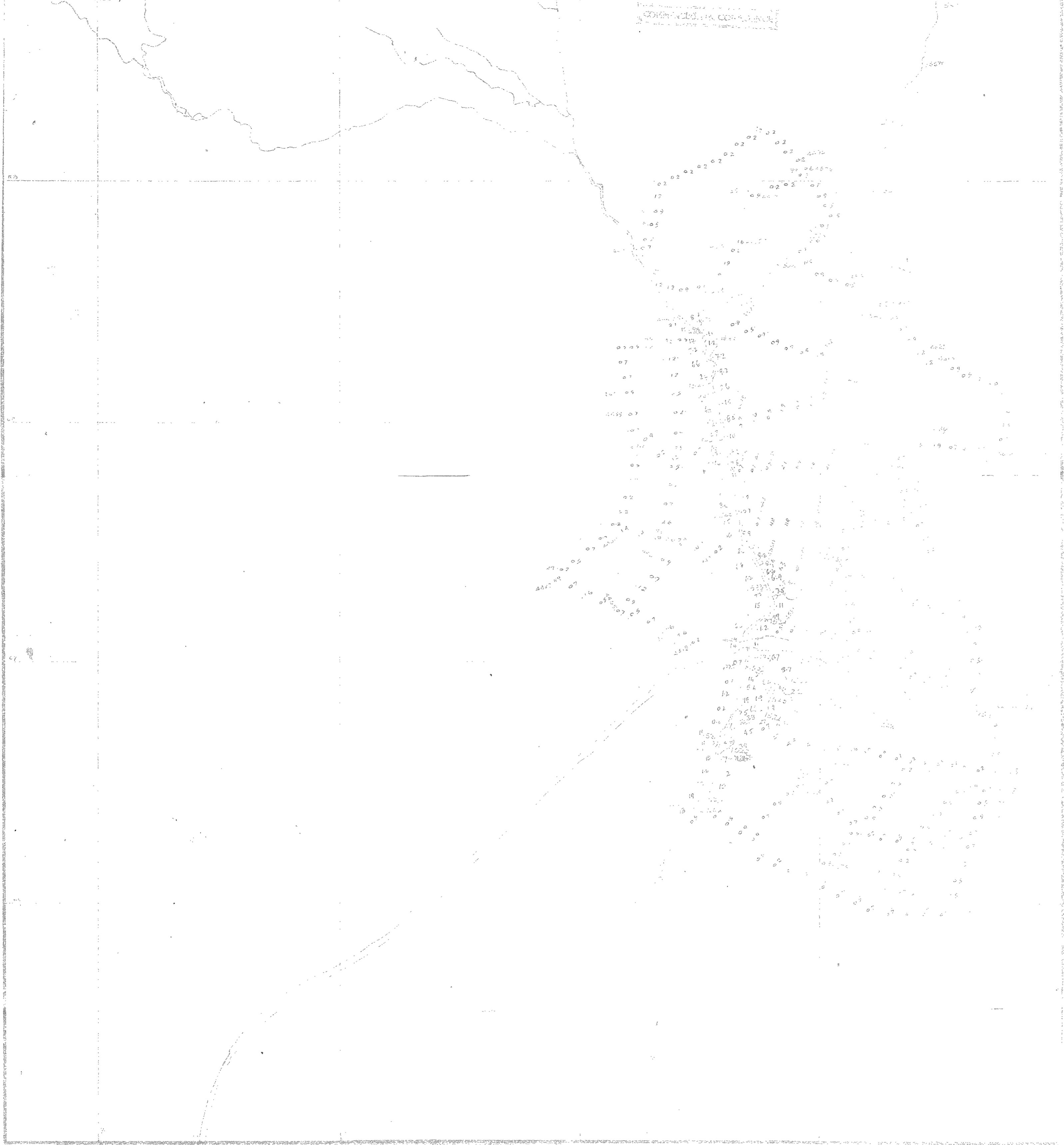

Consolidated Gold Fields Ltd.

Consolidated Gold Fields Ltd.
EXPLORATION

TALNOTRY MO AREAS **AE3/4**

LITTLE WATER of FLEET

MOLYBDENUM ppm. So. Sampling 4437 Sample No

METHOD "B"

- 0-2 ppm Mo
- 5-9 ppm Mo
- 10-19 ppm Mo
- >20 ppm Mo

Scale 6" NX 56NE GLP

1" Geological Map X 4 BR

Scale 6 inch = 1 mile MAY 1952

THESE ARE

Notes

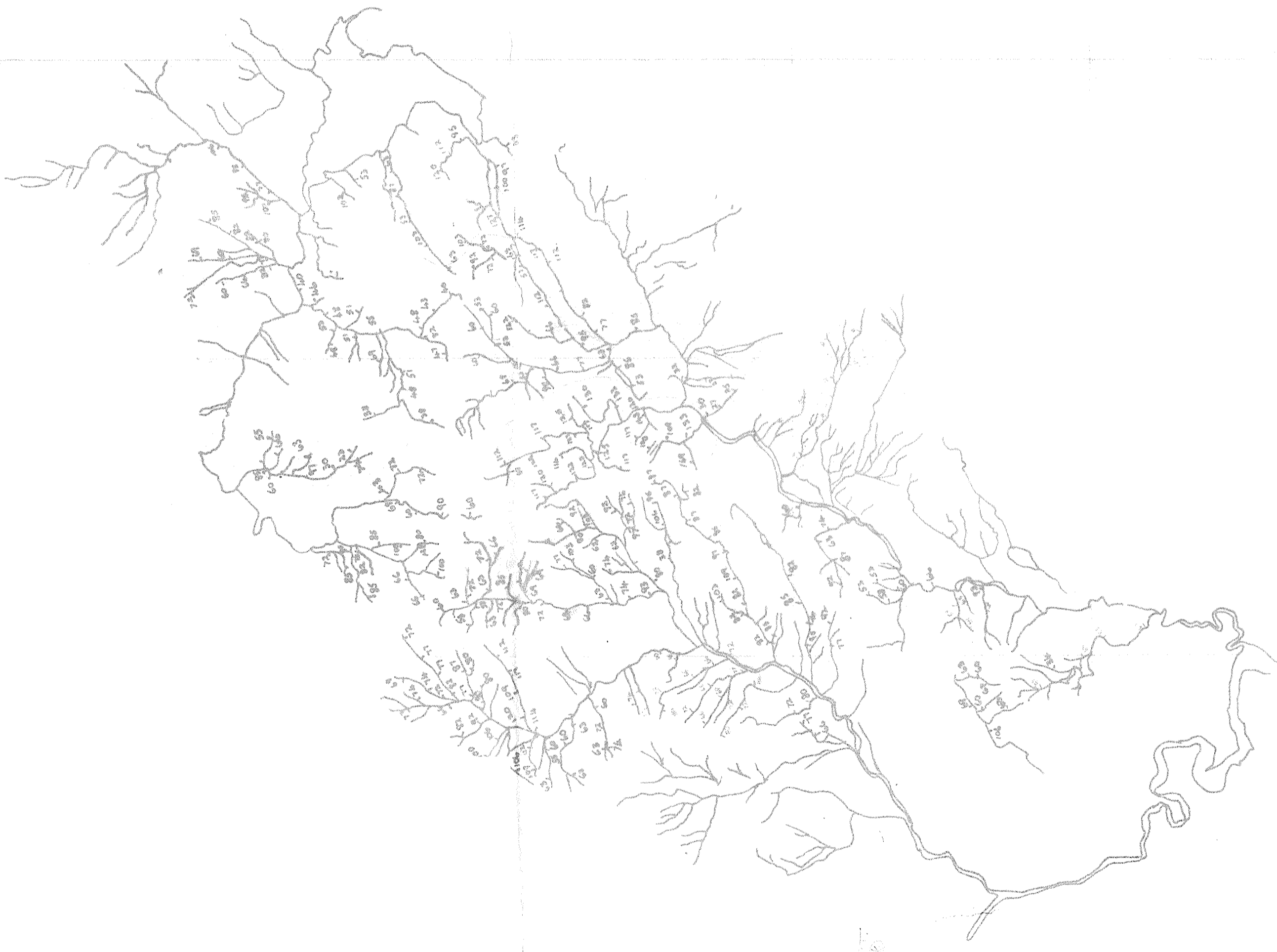
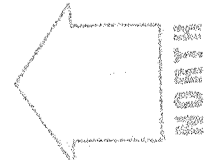

Consolidated Gold Fields Ltd.

EXPLORATION

Title

STREAM SEDIMENT SAMPLING, NICKEL,
TALNOTRY.

AE313

Diag. No

O.S. MAP No 73

Prepared by E.R.P.

Geological Map No 4,5

Drawn by E.R.P.

Date Nov. 1971

Checked by

Scale 1" to 1 mile

Revised by

COMMERCIAL: IN CONFIDENCE



CONSOLIDATED GOLD FIELDS LTD.
SCOTTISH EXPLORATION

TALNOTRY. **AE3/2**
G₁ M₀

SCALE: 1:50,000	PREPARED: J. J. ...	DATE: 20/11/77	FIG No.:
O.S. SHEET No. 11	DRAWN: J. J. ...	REVISED:	DRG. No.:
GEO. SHEET No.:			

LOW MEDIUM HIGH
ORGANIC CONTENT SYMBOLS